

2005-08 ACCESSORIES AND EQUIPMENT

Hood - RL

HOOD ADJUSTMENT

1. Remove these items:
 - Upper grille cover (see UPPER GRILLE COVER REPLACEMENT)
 - Upper grille (see UPPER GRILLE REPLACEMENT)
 - Cowl cover upper trim (see COWL COVER REPLACEMENT)
 - Hood support strut, both sides (see HOOD SUPPORT STRUT REPLACEMENT)
 - Hood latch cover (see step 2 under HOOD LATCH REPLACEMENT)
2. Slightly loosen each hood hinge bolt.
3. Adjust the hood alignment (A) in this sequence.
 - Adjust the hood right and left, as well as forward and rearward, by using the elongated holes in the hood hinges (B).
 - Turn the hood edge cushions (C), as necessary, to make the hood fit flush with the body at the front and side edges.

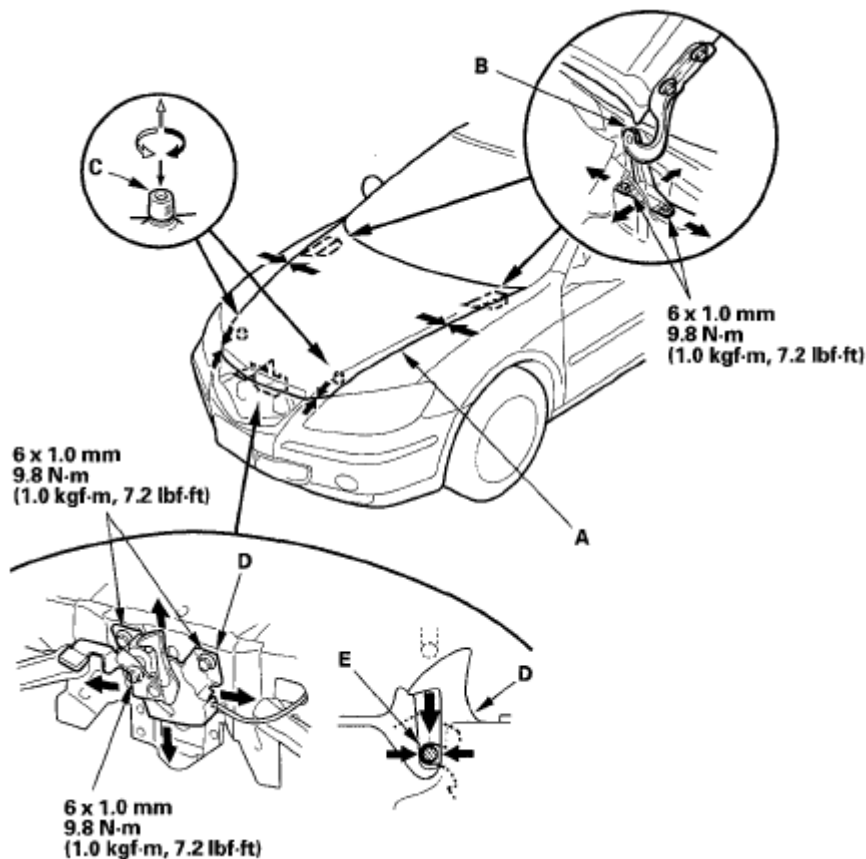

Fig. 1: Identifying Hood Alignment, Hood Edge Cushions And Hood Hinges With Torque Specifications

Courtesy of AMERICAN HONDA MOTOR CO., INC.

4. Adjust the hood latch (D) to obtain the proper height at the forward edge, and move the hood latch right or left until the striker (E) is centered in the hood latch.
5. Tighten the bolts to the specified torque.
6. Check that the hood opens properly and closes securely.
7. Apply touch-up paint to the hinge mounting bolts and around the hinges, and let the paint dry.
8. Apply multipurpose grease to the hood latch and hood hinges as indicated by the arrows.

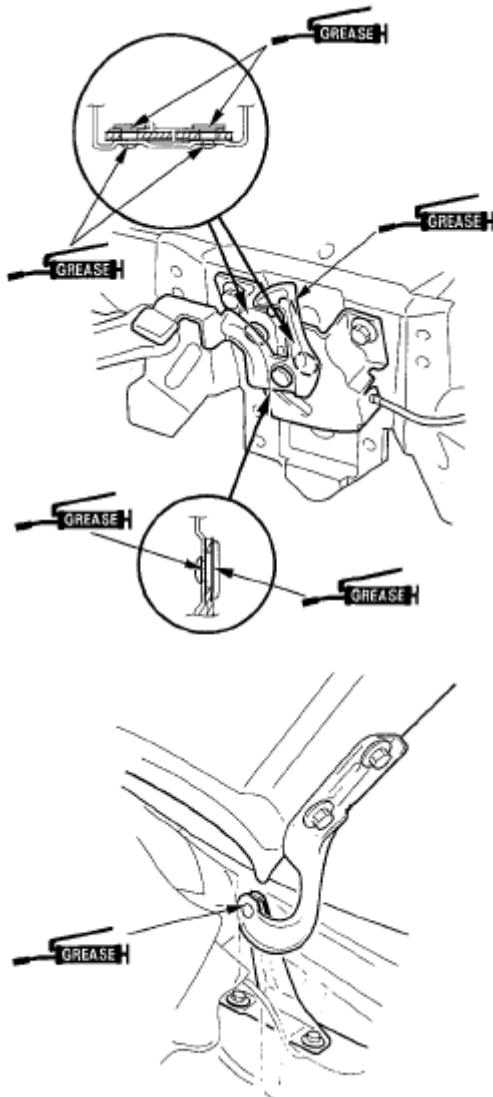

Fig. 2: Applying Multipurpose Grease To Hood Latch And Hood Hinges
 Courtesy of AMERICAN HONDA MOTOR CO., INC.

9. Reinstall all of the removed parts.

HOOD SUPPORT STRUT REPLACEMENT

NOTE:

- Have an assistant help you when removing and installing the support strut.
- Take care not scratch the body and hood.

1. Remove the pivot bolt (A) from the body.

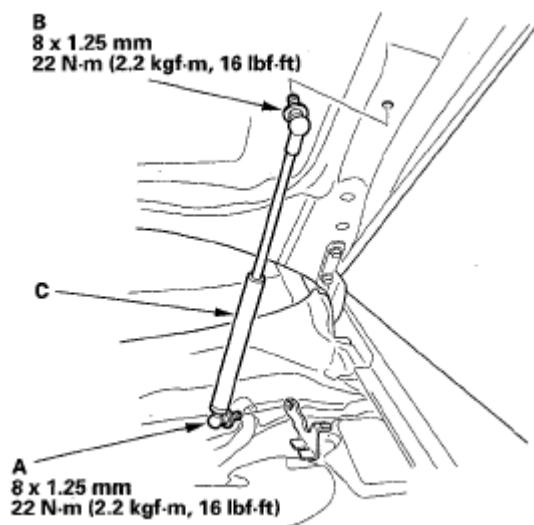

Fig. 3: Identifying Pivot Bolt Of Body With Torque Specifications
 Courtesy of AMERICAN HONDA MOTOR CO., INC.

2. Remove the pivot bolt (B) from the hood, then remove the support strut (C).
3. Install the support strut in the reverse order of removal.

HOOD SEAL REPLACEMENT

1. Using a clip remover, detach the clips, then remove the hood seals (A, B). Take care not to scratch the hood.

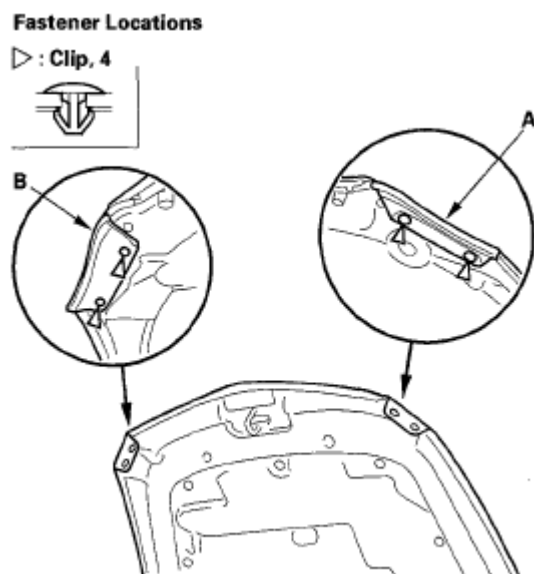

Fig. 4: Identifying Hood Seals And Fasteners
 Courtesy of AMERICAN HONDA MOTOR CO., INC.

2. Install the seals in the reverse order of removal, and note these items:

- Check if the clips are damaged or stress-whitened, and if necessary, replace them with new ones.
- Push the clips into place securely.

HOOD INSULATOR REPLACEMENT

1. Using a clip remover, detach the clips. Release the hooks (A), then remove the hood insulator (B). Take care not to scratch the hood.

Fastener Locations

▷ : Clip, 8

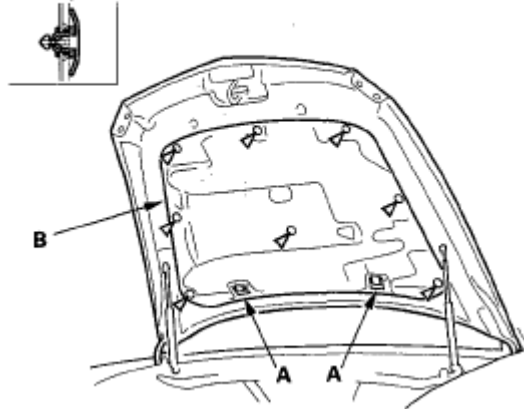

Fig. 5: Identifying Hood Insulator And Fasteners
Courtesy of AMERICAN HONDA MOTOR CO., INC.

2. Install the insulator in the reverse order of removal, and note these items:
 - Check if the clips are damaged or stress-whitened, and if necessary, replace them with new ones.
 - Push the clips into place securely.